

# Welcome to iSC Canvas Help Pages

Learn - Love - Lead

## Home Page 中文

(<https://ldi.instructure.com/courses/5164/pages/home-page-zhongwen>) || Home page 한국어

(<https://ldi.instructure.com/courses/5164/pages/home-page-hangugeo>)

## HOW TO LOG IN TO CANVAS THE 1st TIME

1. Go to <https://Canvas.LDI.Global> (<https://canvas.ldi.global>).
2. Click on "[Parent Login](https://ldi.instructure.com/login/canvas)" (<https://ldi.instructure.com/login/canvas>)."

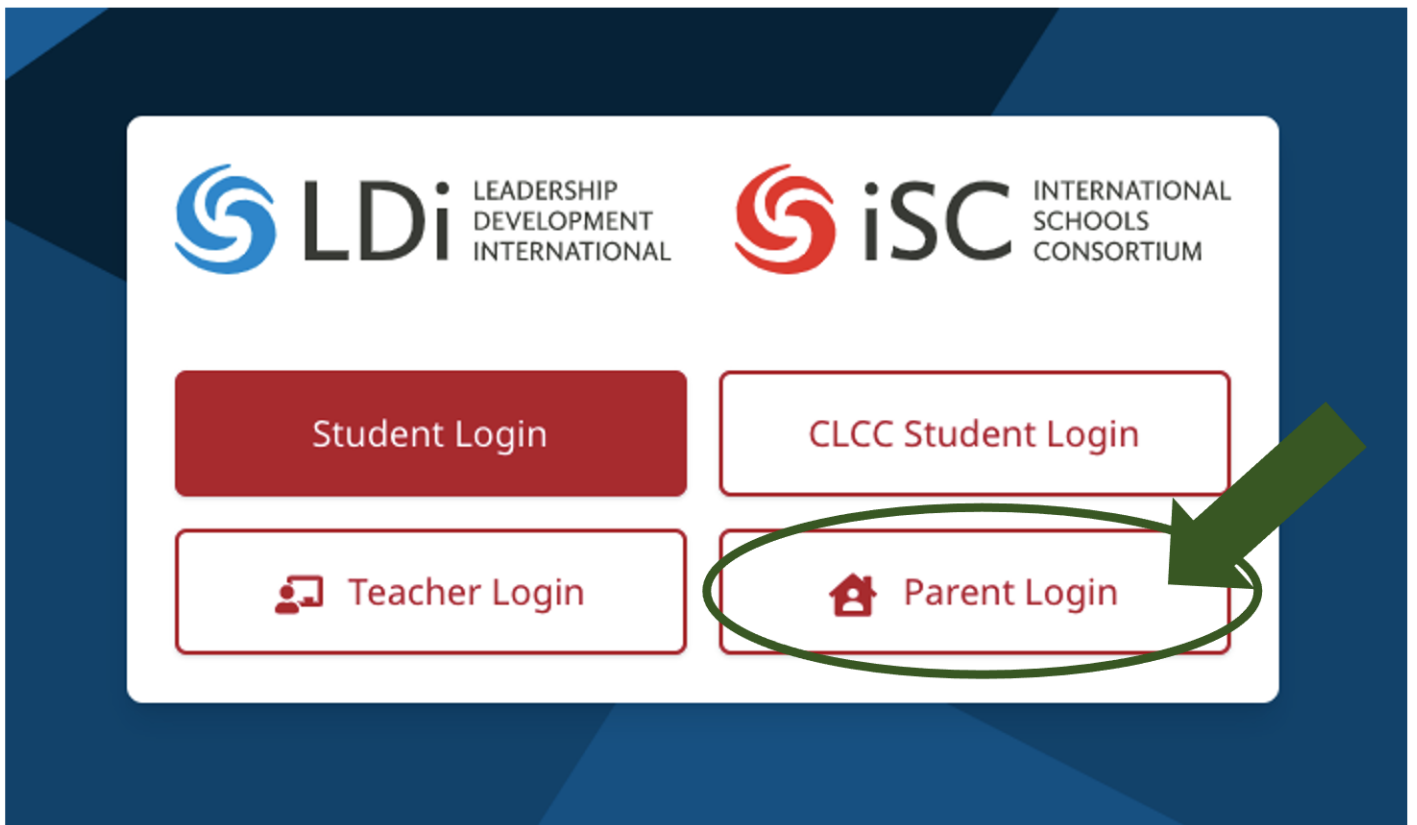

<https://ldi.instructure.com/login/canvas>

3. The **1st time** you log in, please Click "**Forgot Password** (<https://ldi.instructure.com/login/canvas>)" to **set a Password** for Canvas.

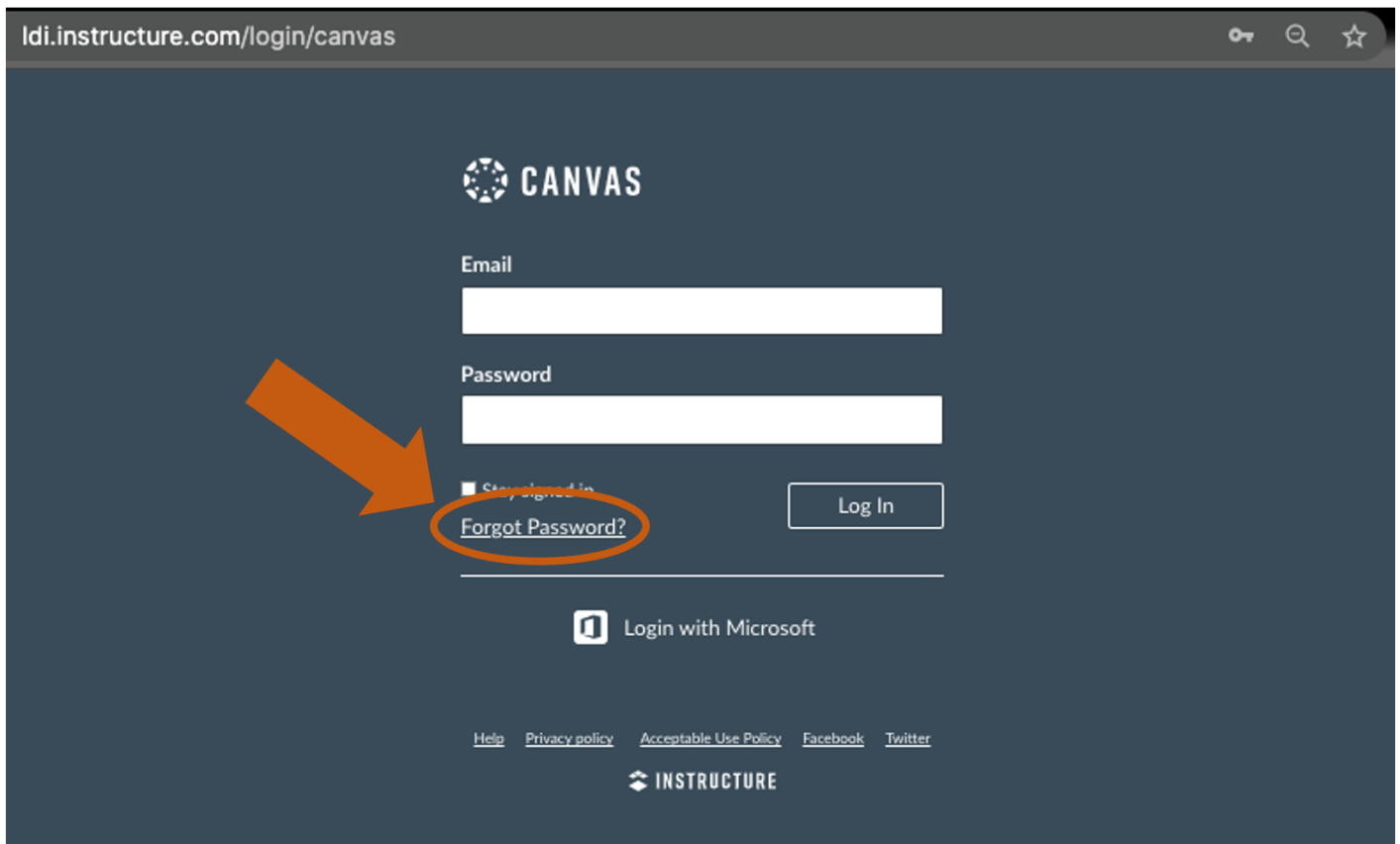

4. **Enter the email** you put into PowerSchool (or the email where you receive school updates).

Then click **"Request Password"**

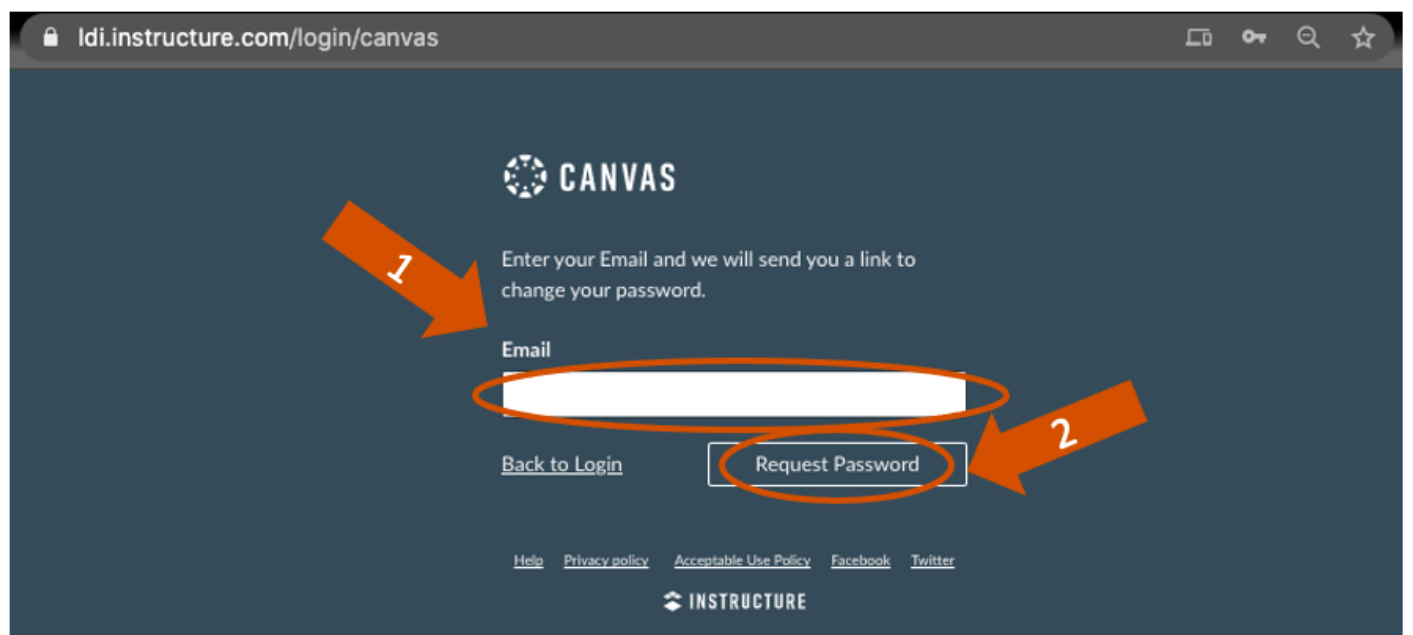

5. Check your email. Canvas will have sent you an email like this:

click: "**Click here to set a new password**"

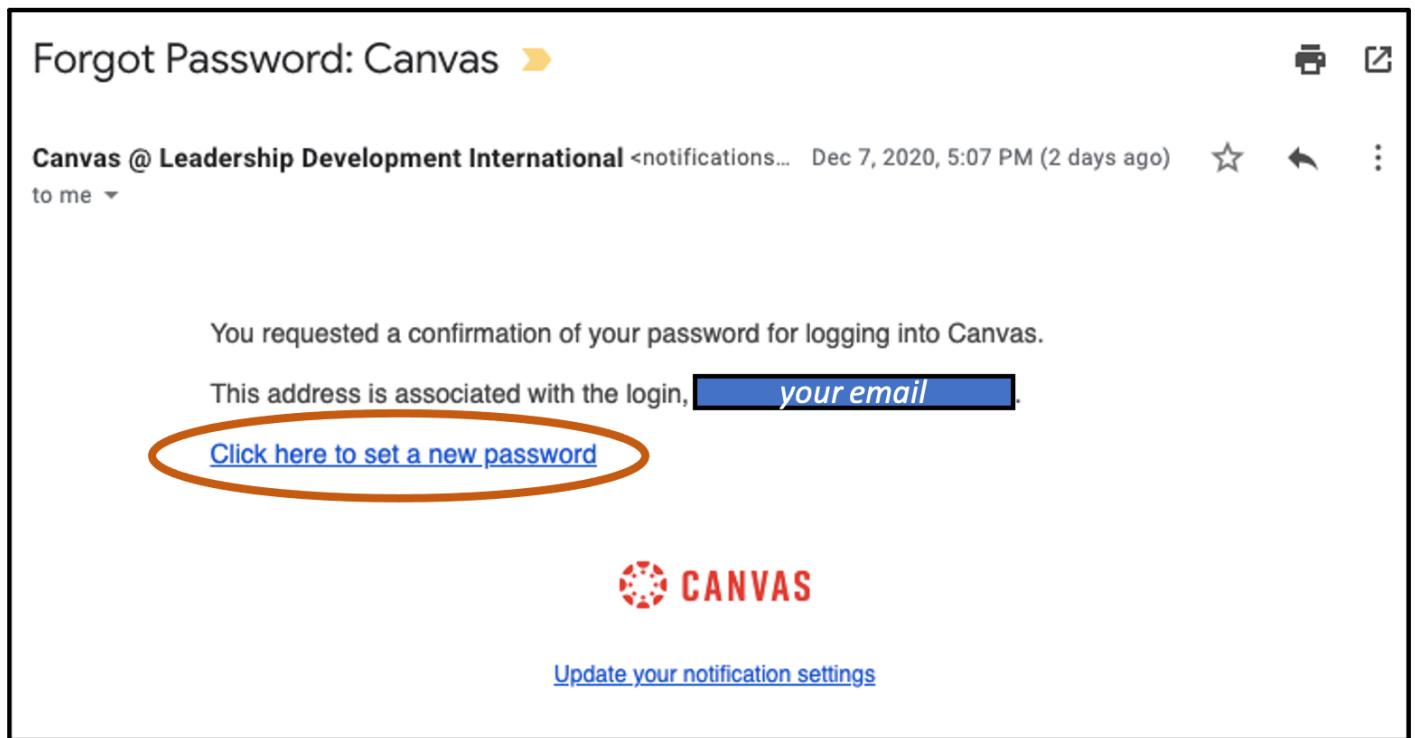

6. A screen like this will show. **Set a password** for Canvas.

The screenshot shows the "Change login password" form. It includes fields for "New password:" and "Confirm new password:", and an "Update password" button. The form is titled "Change login password for [Your name]" and the email address "[Your email]" is also displayed.

7. Return to **Canvas.LDI.Global**

**(<https://ldi.instructure.com/login/canvas>)** - click on "Parent Login"

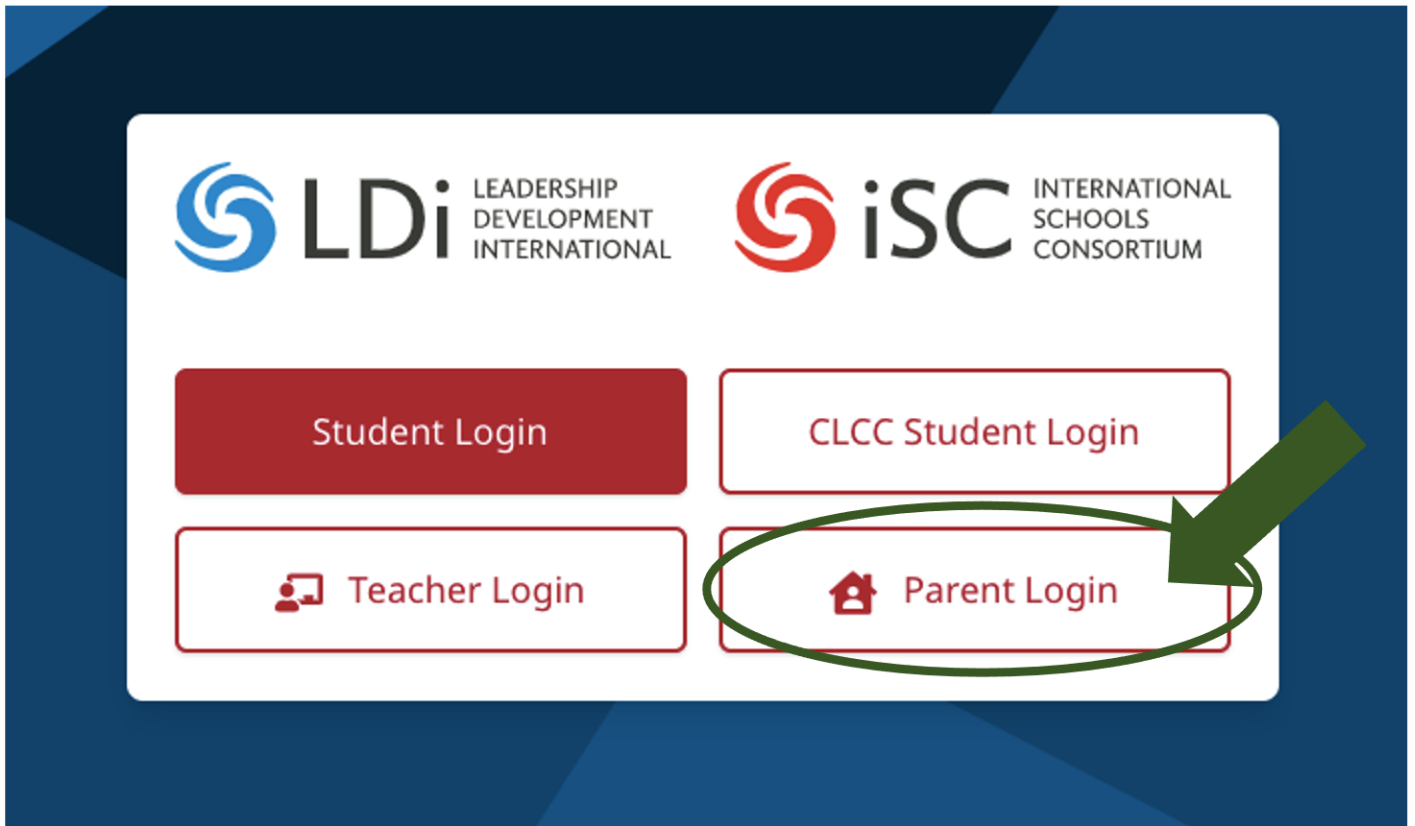

<https://ldi.instructure.com/login/canvas>

8. Use your email and newly set password.

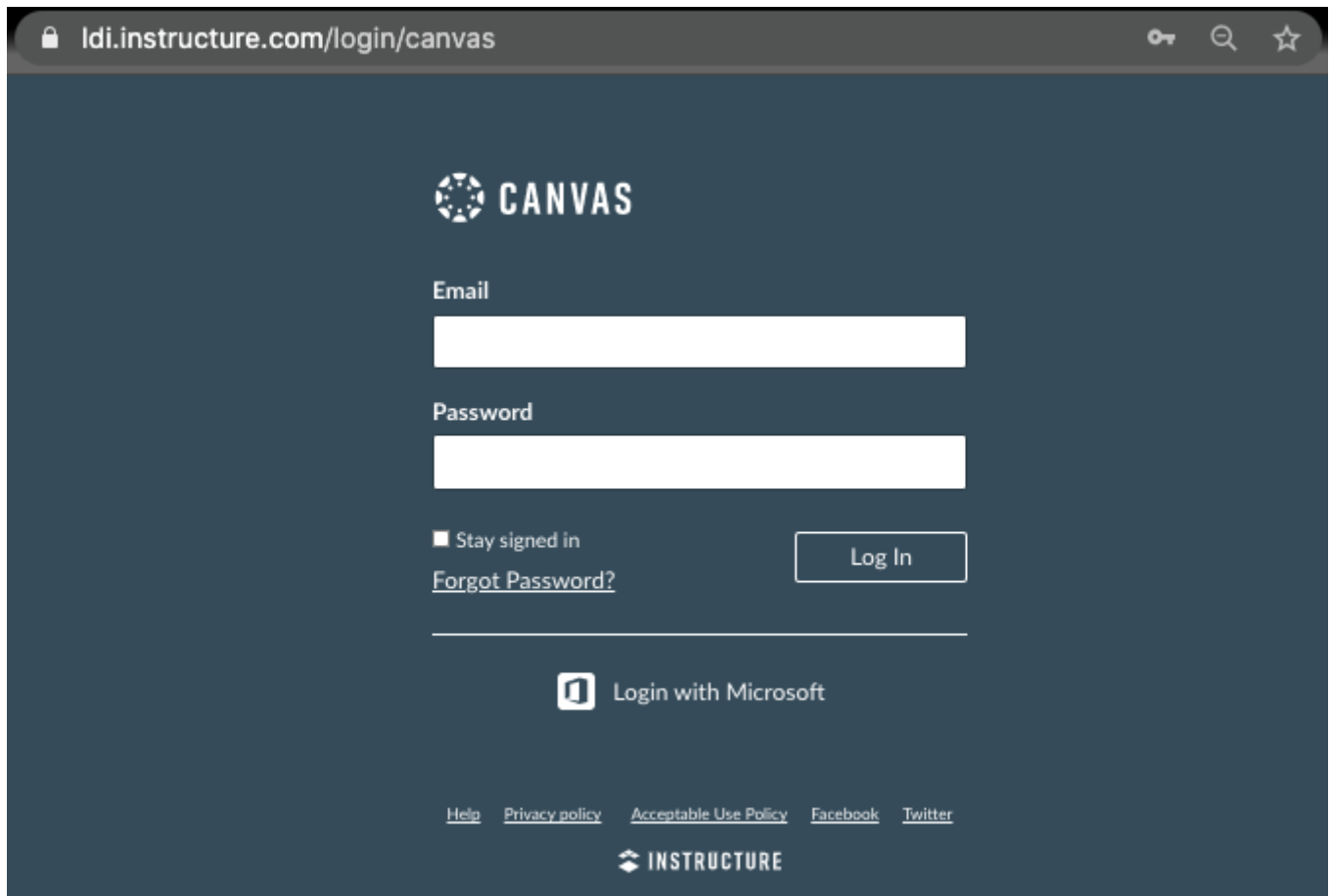

## Once logged in, you will see your Dashboard:

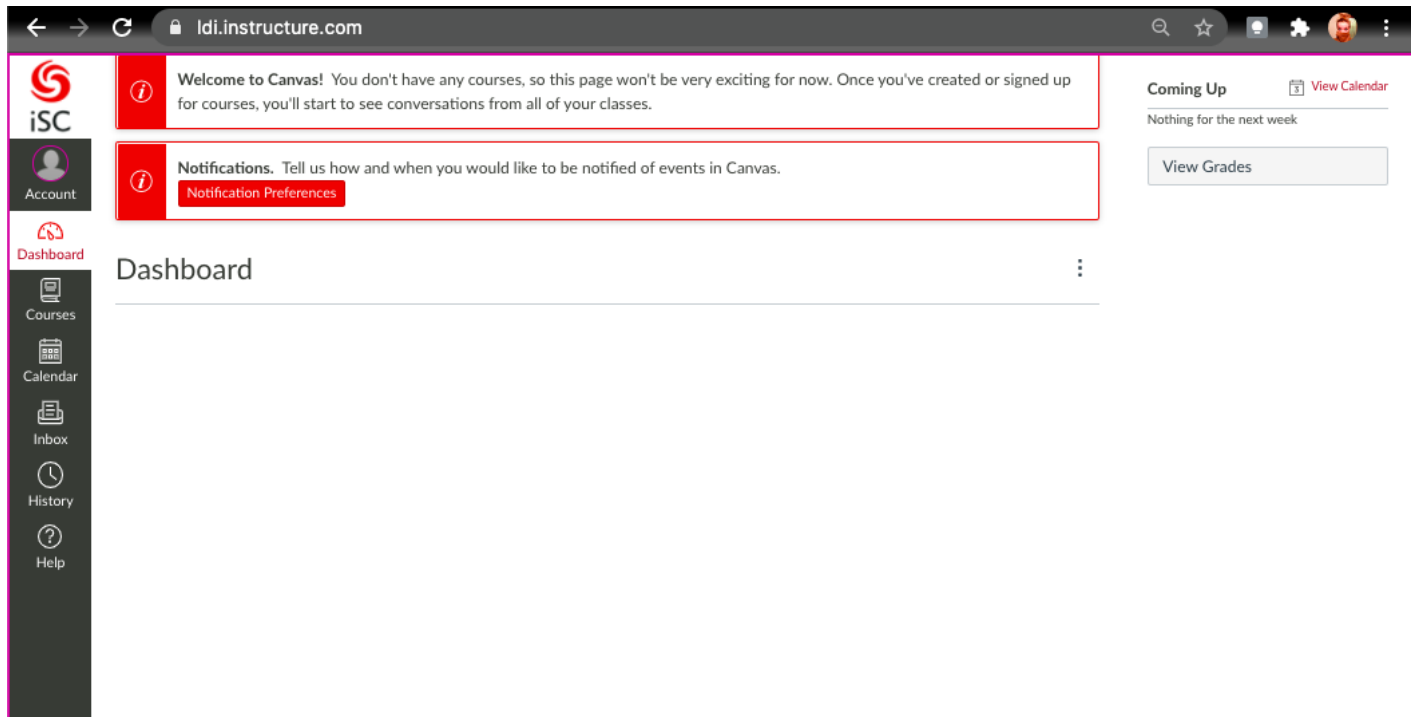

## Set your notifications

(<https://ldi.instructure.com/courses/5164/pages/setting-notifications>)

## Prefer a Different Language?

(<https://ldi.instructure.com/courses/5164/pages/prefer-a-different-language>)